

APPLICATION FOR A TEMPORARY PERMIT

Groundwater Surface Water



State of Kansas

STATUTORY FILING FEE OF \$200.00 MUST ACCOMPANY THIS APPLICATION
(Make check payable to the Kansas Department of Agriculture)

1. Applicant: (Please print or type)
 Name: _____
 Mailing Address: _____
 City and State: _____
 Zip Code: _____ Telephone No. (____) _____
 Email Address: _____

2. Location of Point of Diversion:
 Sec. _____, Twp. _____, Rng. _____, (E/W),
 _____ County, Kansas.

 Distance from Southeast Corner of Section:
 _____ feet North from Southeast Corner (FSL)
 _____ feet West from Southeast Corner (FEL)
 Existing well? Yes No
 Existing permit or water right? Yes No

 If yes, File No. _____

3. Water Use Data:
 Proposed Max. Pumping Rate (gpm) _____
 Amount Requested (gallons) _____
 (not to exceed four million gallons unless for dewatering)
 Depth of Well (feet) _____, **OR**
 Name of Stream _____

4. Water is to be used for (briefly describe proposed use):

Please note that K.A.R. 5-9-4 limits temporary permits to one (1) project per application.

5. Location of Place of Use:
 Sec. _____, Twp. _____, Rng. _____, (E/W),
 Project name and description:

6. Period of Use (6 months maximum):
 Commencing Date: _____
 Ending Date: _____

7. Location of the proposed point of diversion shall be indicated on the diagram below. Use the center section.

If surface water, indicate on the diagram the course of the stream, and its name.

The scale of the diagram is 2 inches = 1 mile
 Each small square represents 10 acres

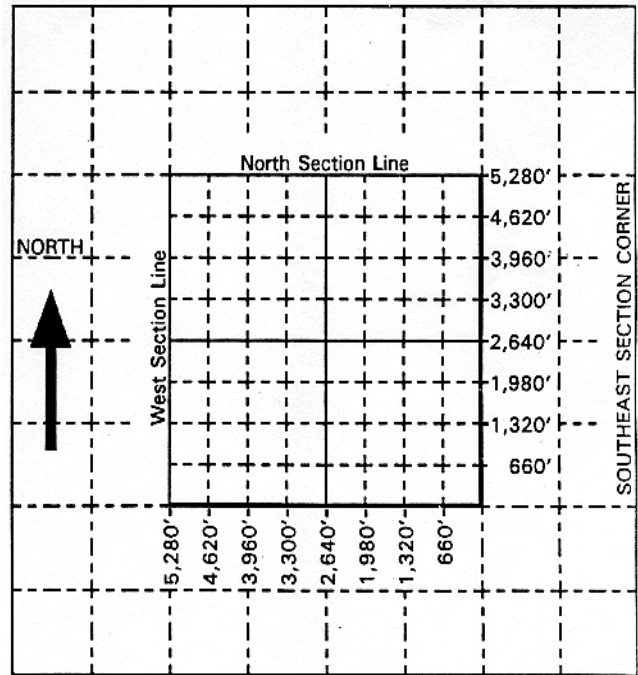

For Office Use Only:									
F.O. Code	GMD	Meets K.A.R. 5-9-1 (YES / NO)	Use	Source	G / S	County	By	Date	
	TMP	Fee \$ 200	TR #	Receipt Date		Check #			

8. For groundwater use, list below all wells within 1/2 mile of the proposed well, and plot locations upon the diagram on reverse side. If additional space is needed, attach sheet.

Well A Owner(s): _____
 Address: _____

Well B Owner(s): _____
 Address: _____

9. For surface water use, list below the names and addresses of all landowners from a point 1/2 mile upstream to a point 1/2 mile downstream of the tract of land upon which the point of diversion is located. If additional space is needed, attach sheet.

Tract A Owner(s): _____
 Address: _____

Tract B Owner(s): _____
 Address: _____

10. The landowner at the location of the point of diversion and water source is:

 (name, address and telephone number)

You must provide evidence of legal access to, or control of, the point of diversion from the landowner or the landowner's authorized representative. Provide a copy of a recorded deed, lease, easement or other document with this application. In lieu thereof, you may sign the following sworn statement:

I have legal access to, or control of, the point of diversion described in this application from the landowner or the landowner's authorized representative. I declare under penalty of perjury that the foregoing is true and correct.

Executed on _____, 20____. _____
 Signature of Applicant

11. The applicant states that the information set forth herein is true and accurate to the best of his/her knowledge.

Signature of Applicant	or	Authorized Representative	Date
Applicant's Name Printed		Title	

DO NOT WRITE BELOW THIS LINE

CONDITIONS OF APPROVAL:

The applicant shall maintain records from which the quantity of water actually diverted may be readily determined.

The use of water herein authorized shall not be made so as to impair any use under existing water rights or prejudicially and unreasonably affect the public interest.

K.S.A. 82a-728 states in part "(a) except for the appropriation of water for the purpose of domestic use, . . . it shall be unlawful for any person to appropriate or threaten to appropriate water from any source without first applying for and obtaining a permit to appropriate water . . ."

Water wells must be properly constructed by the well driller to comply with Article 30 of the Rules and Regulations as adopted by the Kansas Department of Health and Environment.

All applications filed after April 12, 1984, are subject to minimum desirable streamflow (MDS) requirements identified and established by the Kansas Legislature pursuant to K.S.A. 82a-703c. There may be times, as determined by the Division of Water Resources, when you would be required to cease diversion of water in order to satisfy MDS requirements.